



ECO RACK INSTALLATION

For Models 4001, 4002

A SMALL PARTS LIST:

- Part #1 - LOWER MOUNTING BOLT (Qty 3)
- Part #2 - UPPER MOUNTING BOLT (Qty 2)
- Part #3 - WASHER (Qty 5)
- Part #4 - NUT (Qty 3)
- Part #5 - MOUNTING BRACKET (Qty 2)
- Part #6 - REAR REFLECTOR / LIGHT MOUNT (Qty 1)

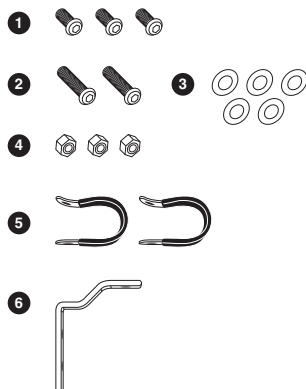

B INSTALLATION

STEP 1.

Mount rack to bike using two **BOLTS (1)** and two **WASHERS (3)** to secure **LOWER RACK MOUNTS** of rack to lower mounts on bike.

STEP 2.

Mount **UPPER RACK MOUNTS** on rack to upper mounts on bike using two **BOLTS (2)** and two **WASHERS (3)**. Extend and/or bend mounts on rack to fit. If bicycle frame does not have upper rack mounts, **MOUNTING BRACKETS (5)**, **NUTS (4)**, **WASHERS (3)** and **BOLTS (2)** can be used.

STEP 3.

Mount **REAR REFLECTOR / LIGHT MOUNT** to rack using one **BOLT (1)**, one **WASHER (3)** and one **NUT (3)**. Mount reflector or rear light (not included) to bracket.

Finish installation by checking all hardware to ensure it is secure.

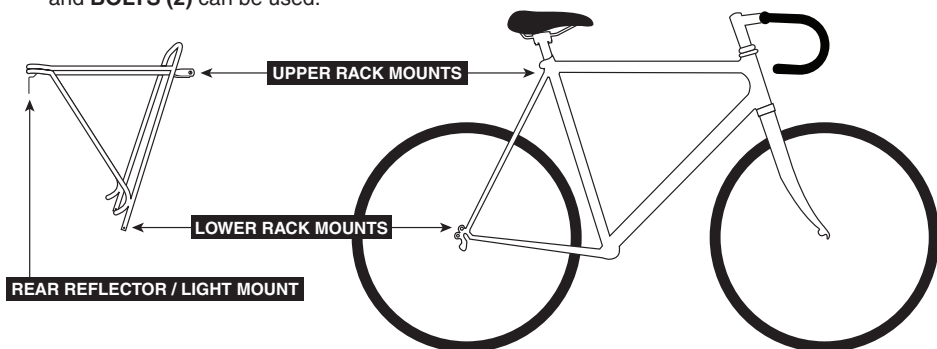

Planet Bike Warranty: We offer a limited lifetime warranty on this product. This includes defects in workmanship and material for the original owner. Warranty does not cover damage due to accident, abuse, or normal wear and tear. Proof of purchase is required. Contact your Planet Bike dealer or Planet Bike.

Planet Bike
2402 Vondron Road
Madison, WI 53718

©2008 Planet Bike. All Rights Reserved.